

SHARDOR

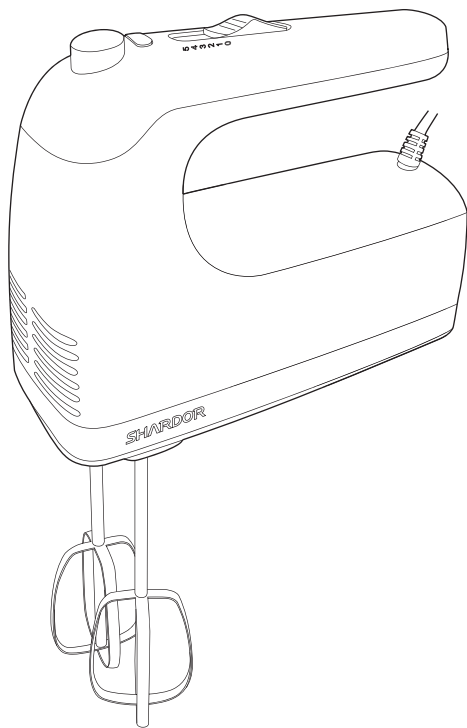

HM315W | Hand Mixer

USER MANUAL

CONTENTS

| | |
|-----------------------------|---|
| ■ Specifications | 1 |
| ■ Product Description | 1 |
| ■ Tips | 2 |
| ■ Operation | 3 |
| ■ Cleaning | 3 |
| ■ Precaution | 4 |
| ■ Warning | 5 |
| ■ Troubleshooting | 5 |
| ■ Warranty | 6 |
| ■ Customer Service | 6 |

Specifications

| | |
|-----------------|--------------------|
| Name | Hand Mixer |
| Model | HM315W |
| Rated Voltage | 120V(US)/ 230V(UK) |
| Rated Frequency | 50-60HZ |
| Rated Power | 350W |

Product Description

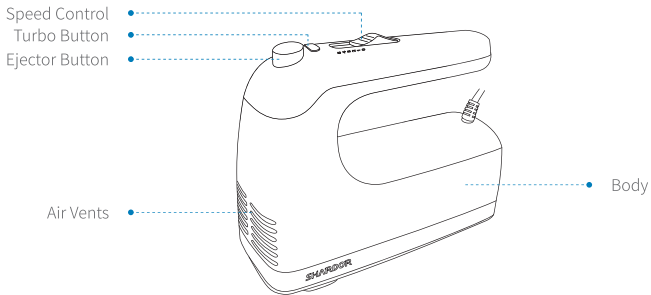

Beaters



Left
Dough Hook



Right
Dough Hook



Storage Box

Tips

• Installing Hooks



1. Insert the hook with the collar into the left opening. Align and push to lock into place.
2. Insert the accessory without a collar into the right opening. Align and push to lock into place.

• Note

1. Do not install the hooks in wrong holes.
2. An accessory shaft without a collar may be used in either opening. If the dough hooks install reversely, the flour may get into the machine.

• Removing Accessories

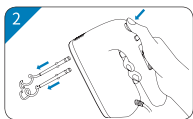

1. If the Hand Mixer is running, stop the Hand Mixer by sliding the Power switch to the "0" (Off) position.
2. Press the ejector button to release the accessories from the Hand Mixer, then remove them.

• Note

1. Make sure the speed button at "0" before plug on.
2. It should be allowed to cool down for 30 seconds after operated for 3 minutes.

Operation

1. Collect all your ingredients together before starting. Choose a mixing bowl that has plenty of room for the mixture.
2. Add the first ingredients to the mixing bowl. Set the OFF/Speed switch to "0"(off).
3. Plug the power cable into a mains outlet.
4. Holding the mixer by the handle, place the beaters or dough hooks into the mixture and gradually increase the mixing speed in the range 1 to 5 until you reach the speed you want.
5. Move the beaters around a little in the mixture to help it circulate. Keep the beaters immersed in the mixture at all times to avoid splashing the mixture from the spinning beaters.
6. If you need to add ingredients or redistribute the mixture in the bowl, switch off the mixer first.

Cleaning

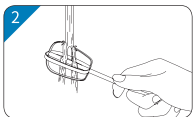

1. Always unplug Hand Mixer before cleaning.
2. Always remove accessories from Hand Mixer before cleaning. Wash in dishwasher, or using warm, soapy water. Rinse and wipe dry.
3. Wipe Hand Mixer with a damp cloth. Dry with a soft cloth.

Precaution

1. Do not use other power except 120AC.
2. Please use 6A socket single alone.
3. Hold the plug and plug in stably.
4. Hold the plug and plug off stably.
5. Do not plug off by pulling the power cord.
6. Don't scratch the machine with anything hard.
7. Always pull out the plug after using the machine.

1. It should be allowed to cool down for 30 seconds after operated for 3 minutes, which will help prolong the life of the product.
2. Beater and hooks are not allowed to use together.
3. Before installing or uninstalling the beaters or hooks, please plug off and the speed button should be at "0" position.
4. Please use the accessories provided by our company.

Warning

1. Any engine disassembly, repair should be executed by qualified technician.
2. This appliance shall not be used by children. Keep the appliance and its cord out of reach of children.
3. Do not plug on/off with wet hands.
4. Do not wet the appliance or put it into water.
5. Finger, clothes, fur or hair should be away from the rotating parts when the appliance is working.
6. A beater and a hook are not allowed to use together.
7. The appliance must be powered off before any assembly and disassembly.
8. Make sure every part is firmly fixed before powering on.
9. If the wire or power cord is damaged, please sent the appliance to factory or service centre.
10. This appliance is for household use only.
11. Children shall not play with the appliance.

Troubleshooting

If Hand Mixer malfunctions or fails to operate: First try the solutions suggested here and possibly avoid the cost of service.

1. Is the Hand Mixer plugged in?
2. Dough hooks installed mistakenly?
3. The ingredients are excessive?
4. Whether the motor is damaged ?
5. Try unplugging the Hand Mixer, then plug it back in.

If the problem cannot be fixed with the steps provided in this section, see "Warranty and Customer Service" section.

Warranty

Limited 12-month Warranty

We warrant this product against any defects that are due to faulty material or workmanship for the life of the product. This warranty does not include damage to the product resulting from accident or misuse. If the product should become defective within the warranty period, we will replace it free of charge.

Please contact us and attach sales receipt with your name, address, phone number and order number. We will be happy to your service.

This warranty does not cover products damaged by the following

1. Accident, misuse, abuse or alteration of the product.
2. Servicing by unauthorized person.
3. Using unauthorized accessories.
4. Connecting it to incorrect current and voltage.
5. Wrapping cord around appliance causing premature wear and breakage.
6. Any other conditions beyond our control.

Customer Service

For FAQ and more information, please contact us. We will be happy to your service.

After-sale Email: warranty@shardor1.com